

1" Hand Drawn Traverse System INSTALLATION INSTRUCTIONS

Tools Needed:

- Tape Measure
- Hex Key (provided in packaging)
- Drill
- Phillips Head Screw Driver
- Installation hardware appropriate for your wall or ceiling

System Parts:

- Brackets
- Track (with Glides pre-installed)
- Metal Splicer, if needed
- Acrylic Wand

Additional Parts:

- End Caps or
Finials with Cuff

Part A: Install each Bracket onto the Traverse Track.



1. Using the hex key, loosen each Bracket Cradle set screw until the pinwheel washer is at the end of the set screw.

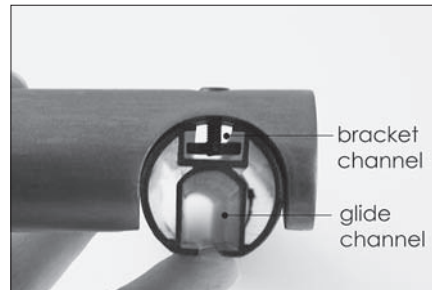

2. At the end of the Track, line up the loosened set screw so that the pinwheel washer fits into the bracket channel.

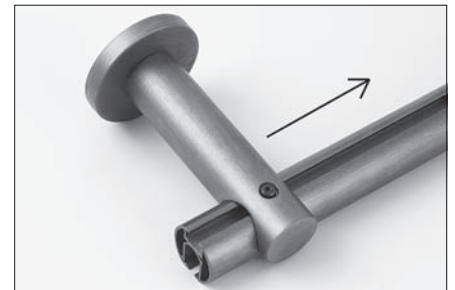

3. Slide each Bracket into its position along the track.

NOTE: Center Support Brackets for spliced tracks do NOT slide into the bracket channel; see Steps 5-9 for spliced tracks.

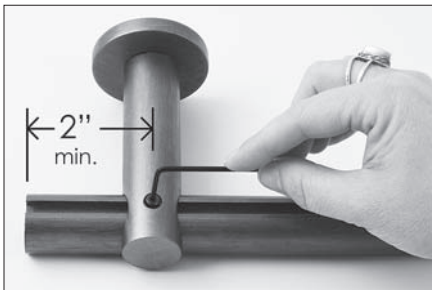

4. Tighten each Bracket Cradle set screw with the hex key.

IMPORTANT: Position the outermost Brackets at each end of the system at least 2" (on center) from the end of the track to allow for the installation of the Finials or End Caps.

If Splicing Tracks:

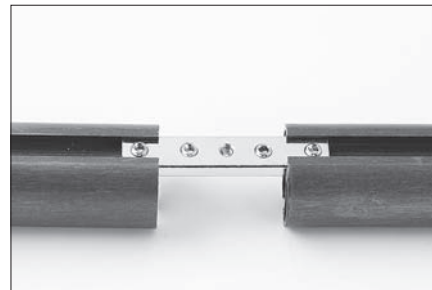

5. Insert the Metal Splicer into the bracket channel of both Tracks.

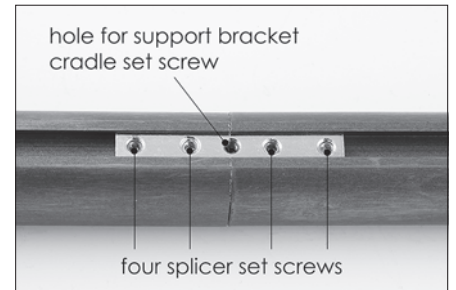

6. Push the two Tracks together as tightly as possible and center the Metal Splicer over the splice. Tighten the four splicer set screws with the hex key.



7. To install the Center Support Bracket, remove the pinwheel washer from the Bracket Cradle set screw.



8. Center the Bracket Cradle set screw over the center hole of the Metal Splicer.



9. Tighten the Bracket Cradle set screw with the hex key.

1" Hand Drawn Traverse System INSTALLATION INSTRUCTIONS

Part B: Install the Traverse System to the wall.

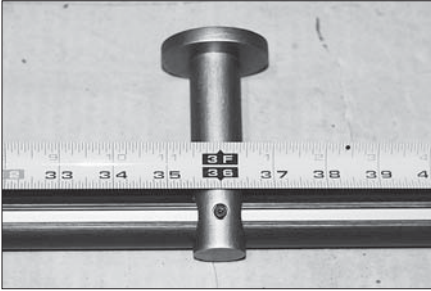

10. Measure the distance between each Bracket with a tape measure.



11. At the correct installation height, mark the position of each Bracket on the wall.

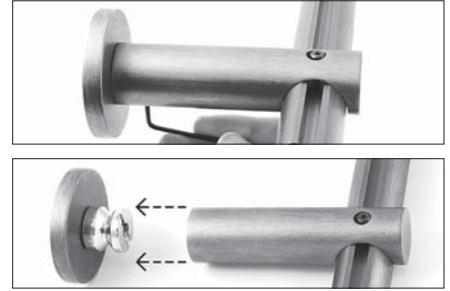

12. Using the hex key, remove each Bracket Base from each Bracket Stem.

NOTE: Bracket Stems will remain attached to the Traverse Track.

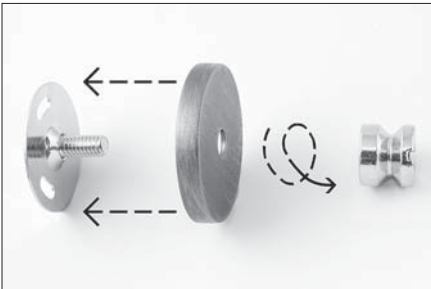

13. Remove the Mounting Plate from each Bracket Base.

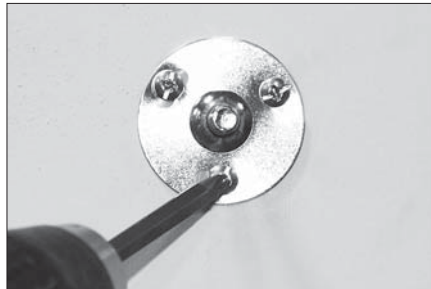

14. Install each Mounting Plate to the wall.

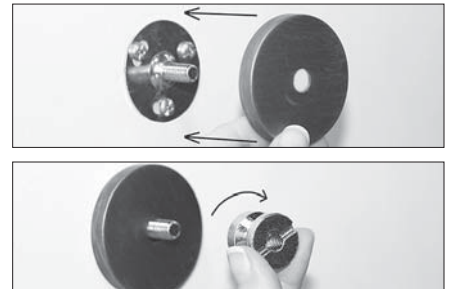

15. Position the Bracket Bases over each Mounting Plate.

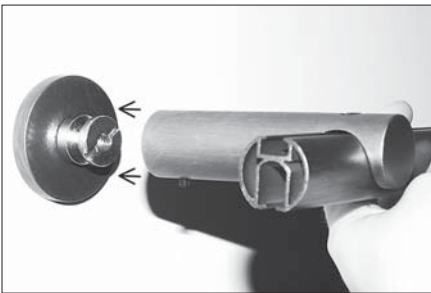

16. Lift Traverse Track and line up the Bracket Stems with the wall-mounted Bracket Bases.

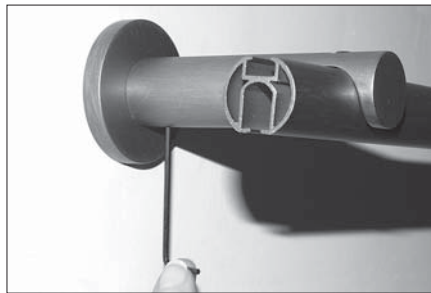

17. Slide the Bracket Stems over the Bracket Bases and Tighten each one with the hex key.

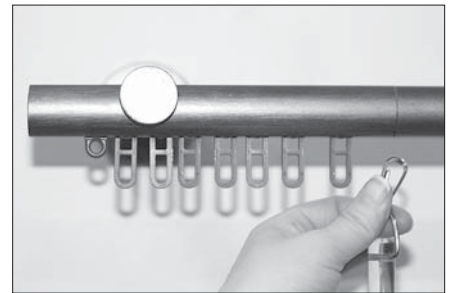

18. Install the Acrylic Wand(s) to the lead Glide(s).

Part C: Install the finials.

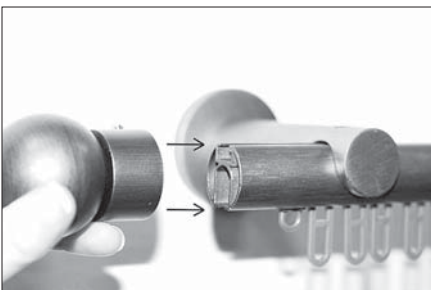

19. Install the End Caps or Finials with Cuff to each end of the Track..

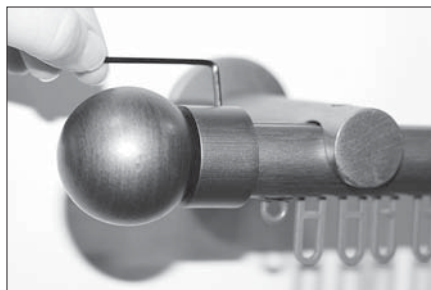

20. Tighten the set screw of the Finial Cuff or End Cap with the hex key.